

GREENFIELD MIDDLE SCHOOL 195 FEDERAL STREET GREENFIELD, MA

ROOF REPAIRS

GENERAL NOTES:

1. ALL WORK SHALL COMPLY WITH THE MASSACHUSETTS STATE BUILDING CODE AND LOCAL CODES AND ORDINANCES.
2. THE CONTRACTOR SHALL APPLY FOR ALL PERMITS, AND SHALL PAY ALL PERMIT RELATED FEES.
3. THE DRAWINGS SHALL BE USED IN CONJUNCTION WITH THE WRITTEN SPECIFICATIONS.
4. CONTRACTORS SHALL SUBMIT SHOP DRAWINGS AND MATERIAL SUBMITTALS FOR REVIEW AS REQUIRED IN THE SPECIFICATIONS.
5. THE CONTRACTOR SHALL VERIFY EXISTING DIMENSIONS OF THE STRUCTURE SHOWN ON THE DRAWINGS PRIOR TO ORDERING MATERIALS.

6. THESE DOCUMENTS DO NOT INCLUDE THE NECESSARY COMPONENTS FOR CONSTRUCTION SAFETY. SAFETY CARE OF ADJACENT PROPERTIES DURING CONSTRUCTION AND COMPLIANCE WITH STATE AND FEDERAL REGULATIONS REGARDING SAFETY. SAFETY SHALL BE THE CONTRACTOR'S RESPONSIBILITY.
7. THE CONTRACTOR(S) SHALL MAINTAIN THE JOB CLEAR OF TRASH AND DEBRIS.
8. THE CONTRACTOR IS RESPONSIBLE FOR DUST PROTECTION, AND WEATHER PROTECTION OF THE BUILDING AND MATERIALS DURING CONSTRUCTION.

DEMOLITION NOTES:

1. WHERE INDICATED ON THE DRAWINGS, STRIP OFF EXISTING ROOF MEMBRANE.
2. WHERE INDICATED, REMOVE EXISTING FLASHING.
3. WHERE INDICATED, REMOVE EXISTING ROOF DRAIN.
4. PROVIDE TEMPORARY WATER-TIGHT ROOFING OVER AREAS WHERE ROOFING HAS BEEN REMOVED.
5. ALL REMOVED MATERIAL SHALL BE DISPOSED OF PER LOCAL, STATE, AND FEDERAL REGULATIONS.

MEMBRANE ROOFING NOTES:

1. SEE SPECIFICATIONS.
2. ROOF MEMBRANE SHALL BE A SINGLE PLY EPDM MEMBRANE AS INDICATED IN THE SPECIFICATIONS.
3. INSTALL ROOF MEMBRANE ACCORDING TO MANUFACTURER'S INSTALLATION REQUIREMENTS. INSTALL MEMBRANE ONLY UNDER DRY, WIND-LESS, AND MODERATE ENVIRONMENTAL CONDITIONS REGARDING TEMPERATURE, AND HUMIDITY. MINIMUM TEMP. DURING INSTALLATION SHALL BE 45° F.
4. FLASHING SHALL BE 60 MIL REINFORCED MEMBRANE WITH BONDING ADHESIVE AND SEALANT AS RECOMMENDED BY MEMBRANE MANUFACTURER.
5. ROOF CONTRACTOR IS TO INSTALL FLASHING AND SEALANT AS REQUIRED TO ASSURE A LEAK-PROOF ROOF.
6. MEMBRANE MANUFACTURER SHALL INSPECT AND CERTIFY THE ROOF PER THE SPECIFICATIONS.
7. CONTRACTOR IS TO PROVIDE A 15 YEAR WARRANTY ON THE AREAS OF THE ROOF WHERE OVERLAYS AND TEAR-OFFS HAVE BEEN COMPLETED.

ROOF INSULATION NOTES:

1. SEE SPECIFICATIONS.
2. CONTRACTOR IS TO DETERMINE THE ELEVATION OF THE EXISTING ROOF DRAINS RELATIVE TO THE ROOF AREA TRIBUTARY TO THE DRAINS.
3. WHERE ROOF TEAR-OFF IS SPECIFIED, RIGID POLYISOCYANURATE INSULATION BOARD SHALL HAVE A MINIMUM THICKNESS OF 3".
4. BASED ON THE ACTUAL SLOPE OF THE ROOF, THE TAPERED INSULATION SHALL BE ORDERED TO ASSURE THAT THE FINISH ROOF SURFACE WILL SLOPE TOWARDS THE DRAINS AT A MINIMUM SLOPE OF $\frac{1}{4}$ PER FT.
5. TAPERED INSULATION SHALL BE CUT TO FORM CRICKETS TO DIVERT WATER AROUND CURBS AND OTHER OBJECTS THAT WOULD PREVENT THE FREE FLOW OF WATER TOWARDS THE DRAINS.

ROOF DRAIN NOTES:

1. SEE SPECIFICATIONS.
2. PROVIDE ROOF DRAINS WHERE INDICATED AND CONNECT TO THE EXISTING DRAIN SYSTEM WITH PIPING AND HARDWARE COMPATIBLE WITH THE EXISTING SYSTEM.

ABBREVIATIONS:

EXIST. = EXISTING
TYP. = TYPICALS
UDA. = UNLESS OTHERWISE NOTED

DESIGN CRITERIA: PER 780 CMR - 8TH EDITION
MIDDLE SCHOOL FLOOR AREA: 13, 140 SF
BUILDING CLASSIFICATION:
USE GROUP: E, EDUCATION
CONSTRUCTION TYPE: IIB
ROOF DESIGN CRITERIA: B. MODERATE EXPOSURE
ROOF COVERING CLASSIFICATION:
WIND LOAD DATA:
V = 100 MPH IMPORTANCE FACTOR 1.15
WIND EXPOSURE B

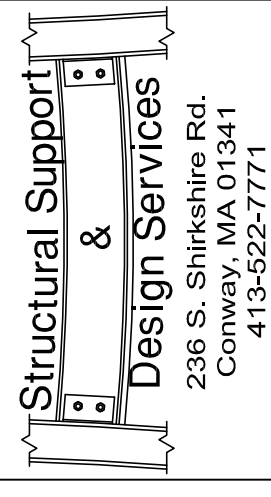

REV: DATE: REVISIONS: BY:
0 06/01/17 RELEASE FOR BIDDING MA

DESIGN BY: MR

PROJECT:
ROOF REPAIRS
GREENFIELD MIDDLE SCHOOL
195 FEDERAL STREET
GREENFIELD, MA

PREPARED FOR:

TOWN OF GREENFIELD
14 COURT SQUARE
GREENFIELD, MA

NOTES

RF1

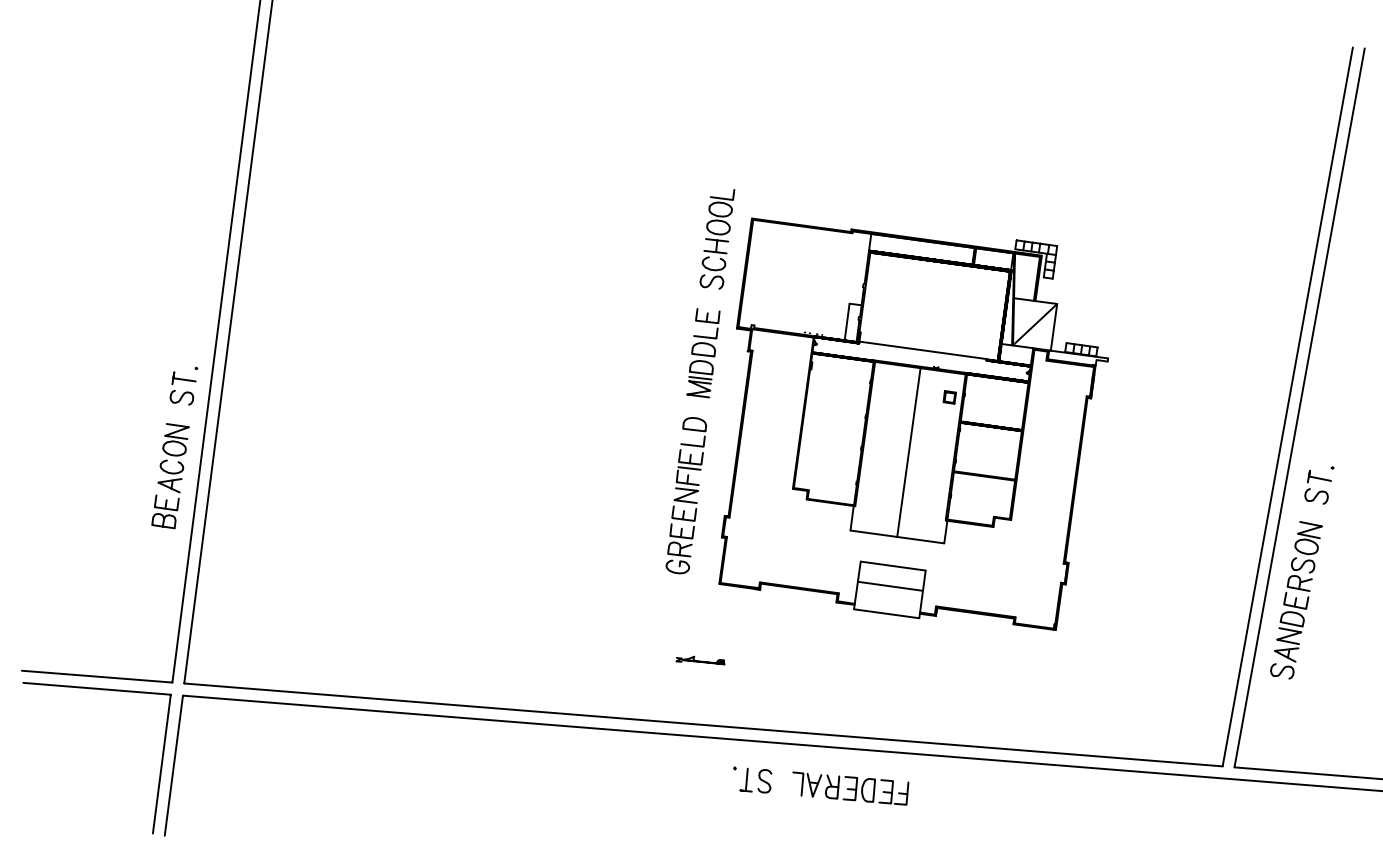

PROJECT LOCUS